

Specification

- Modulating operation
- Compatible with all kinds of boilers
- Optimum fuel air mixture with special gas head and operation by atomizing the fuel mechanically with high pressure from nozzle
- High output operation at each boiler due to adjustment of air flow rate both from suction and from flame tube
- Accessibility to all equipment without dismounting the burner from boiler
- Production in conformity with DIN 4788 and EN 676 standards
- High pressure light weight fan design
- Multi-block bearing safety, operation solenoids, min air pressure switches, filters and regulators on it
- Electrical servomotor with mechanical cam for adjustment of combustion air and fuel simultaneously
- Compact pre-heater specially designed for fuel oil, safety and operation thermostat, second safety surface thermostat, analogue thermometer
- Flame control with photocell
- Hydraulic system in conformity with EN 267
- Automatic control equipment of burner in conformity with the European standard EN 298 and EN 230
- Easy installation and operation
- Low noise level due to light and aerodynamic frame manufactured of high quality aluminum

Model and data base

Type	Gas capacity (KW)	Oil consumption Kg/h	Fan motor power (KW)	Oil Pump Power (KW)	Oil Heater* (KW)	Weight (Kg)
MGL / MGH90	200-1200	22-105	1.5	0.75	6	45
MGL / MGH120	250-1500	35-140	2.2	0.75	9	120
MGL / MGH140	300-2000	40-180	3.0	1.1	14	120
MGL / MGH160	300-2500	40-220	3.0	1.1	14	120
MGL / MGH200	430-3000	62-267	4.0	1.1	14	250
MGL / MGH250	500-3500	76-312	5.5	1.5	18	250
MGL / MGH280	580-4070	95-363	7.5	1.5	18	250
MGL / MGH380	798-5581	104-500	11	1.5	28	270
MGL / MGH400	1150-5800	104-500	11	2.2	28	450
MGL / MGH500	1150-6700	167-550	15	2.2	32	450
MGL / MGH550	1150-7200	183-600	15	2.2	32	450
MGL / MGH800	3000-11500	317-1025	22	4.0	37	600

Heater* for GH burner.

Voltage: 220V / 380V / 50HZ

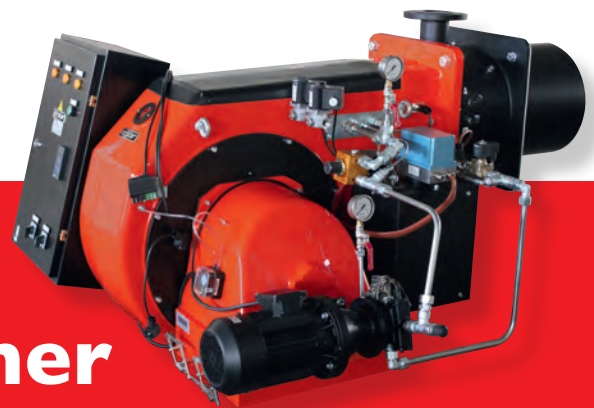

Monoblock Burner Dual Burner MGL/MGH

Capacity Curve

MGL/MGH90

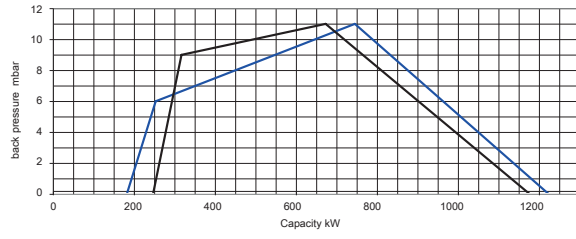

MGL/MGH120

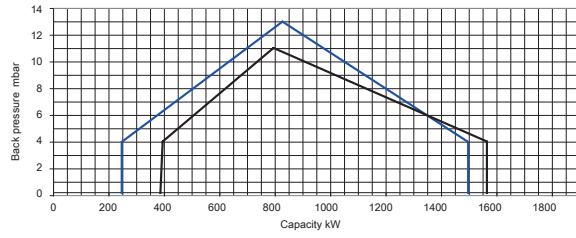

MGL/MGH140
MGL/MGH160

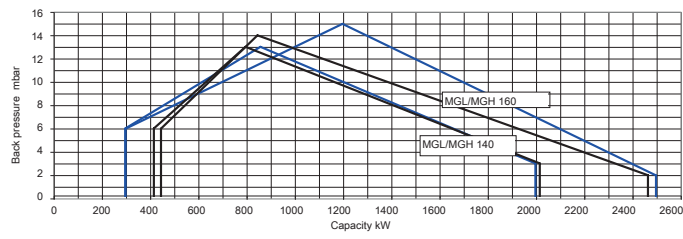

MGL/MGH200

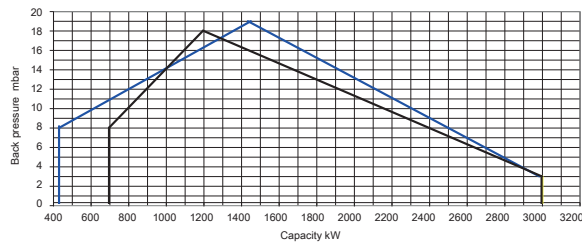

MGL/MGH250

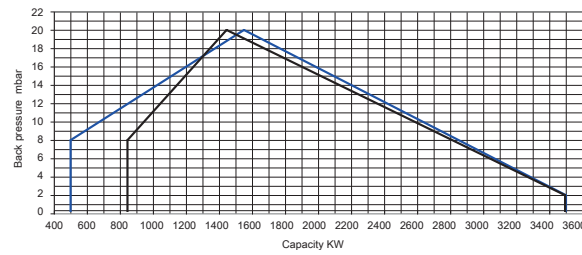

— Gas
— Oil



MGL/MGH280

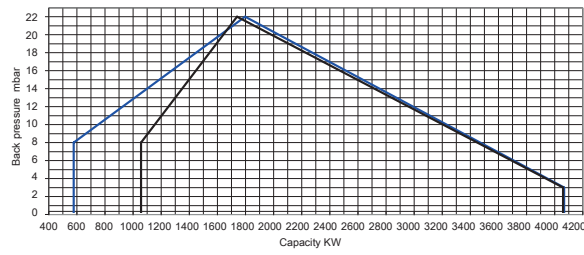

MGL/MGH380

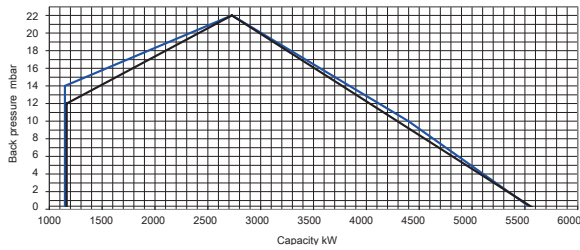

MGL/MGH400
MGL/MGH500
MGL/MGH550

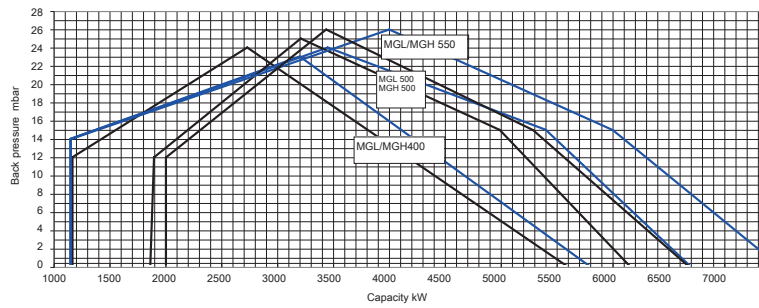

MGL/MGH800

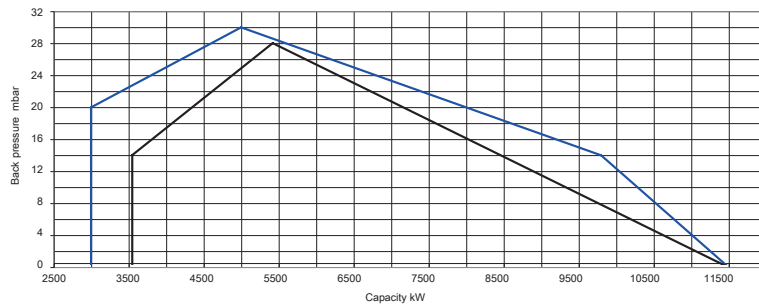

— Gas
— Oil



Dimensions

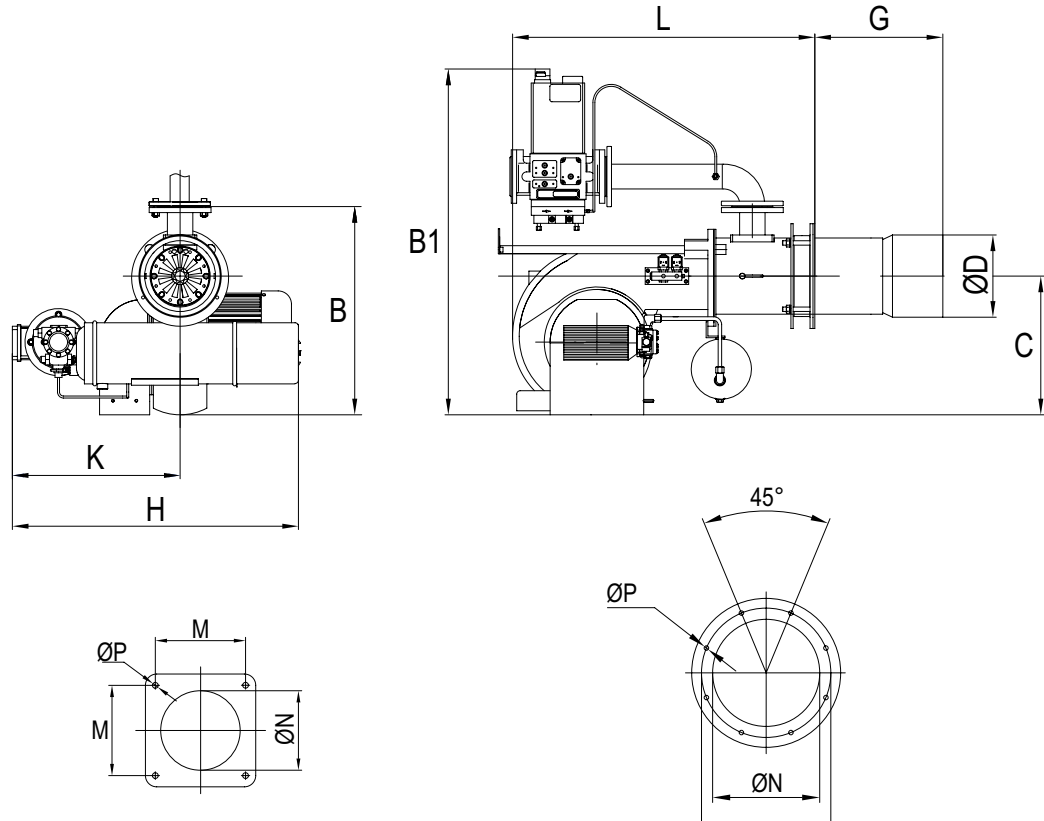

	Gas capacity (KW)	Oil consumption Kg/h	L	Gmin	Gmax	H	K	B	B1	C	ØN	ØP	M	ØD
MGL/MGH90	200-1200	22-105	800	150	350	780	420	455	-	360	149	11	180	200
MGL/MGH120	250-1500	35-140	920	280	500	900	500	615	1020	420	230	18	275	236
MGL/MGH140	300-2000	40-180	920	280	500	900	500	615	1020	420	230	18	275	236
MGL/MGH160	300-2500	40-220	920	280	500	900	500	615	1020	420	230	18	275	236
MGL/MGH200	430-3000	62-267	1000	200	375	1100	550	680	1040	500	240	18	275	240
MGL/MGH250	500-3500	76-312	1000	200	375	1100	550	680	1040	500	250	18	275	280
MGL/MGH280	580-4070	95-363	1000	200	375	1100	550	680	1040	500	250	18	275	280
MGL/MGH380	798-5581	104-500	1200	200	375	970	355	795	1300	525	300	22	335	300
MGL/MGH400	1150-5800	104-500	1400	320	320	1080	530	940	1450	640	377	15	360	375
MGL/MGH500	1150-6700	167-550	1400	320	320	1080	530	940	1450	640	377	15	360	375
MGL/MGH550	1150-7200	163-600	1400	320	320	1080	530	940	1450	640	377	15	360	375
MGL/MGH800	3000-11500	317-1025	1500	350	350	1290	610	1100	1780	826	560	15	Ø630	492

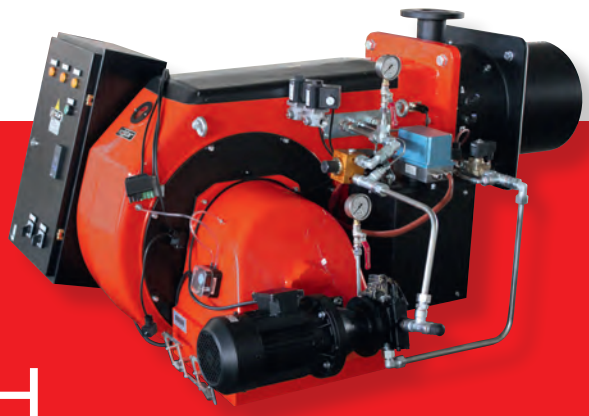

Monoblock Burner
Dual Burner MGL/MGH

Flame size

