

Specification

- Capacity range from 45 to 11000 kW
- Modern design with aluminum body
- Electrical (wise-drive) modulating
- Designed to natural gas, town gas, biogas and mine gas etc.
- EN 676 as standard
- High reliability and lifetime

EMISSIONS

| Burner | NOx | CO |
|-----------------------------|----------------------|----------------------|
| | [mg/m ³] | [mg/m ³] |
| Low-emission (Low NOx) | 50 ÷ 90 | < 50 |
| With flue gas recirculation | * 30 ÷ 70 | < 20 |

* Burner's maximal heat outputs (characteristics) decrease of 15 %

Model and data base

| Type | Capacity (KW) | Weight* (Kg) | Motor (Kw) |
|--------------|------------------|-----------------|---------------|
| MG40-E-LN | 90-500 | 39 | 0,7 |
| MG80-E-LN | 250-1100 | 64 | 0,9 |
| MG100-E-LN | 320-1600 | 73 | 1,4 |
| MG160-E-LN | 500-2600 | 100 | 2,6 |
| MG400-E-LN | 800-4800 | 205 | 6 |
| MG400/I-E-LN | 1100-5000 | 228 | 8 |
| MG700-E-LN | 1700-8000 | 470 | 11 |
| MG900-E-LN | 2500-11000 | 500-580 | 20÷35 |



Monoblock Burner – Low NOx Gas Burner MG-E-LN

Capacity Curve

MG40-E-LN
MG80-E-LN

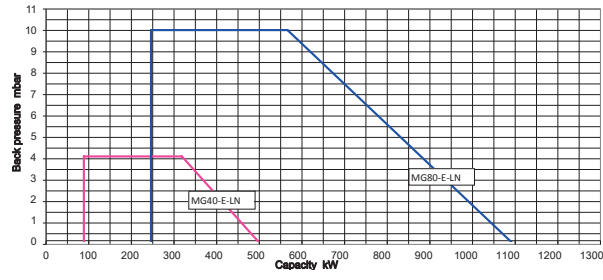

MG100-E-LN
MG160-E-LN

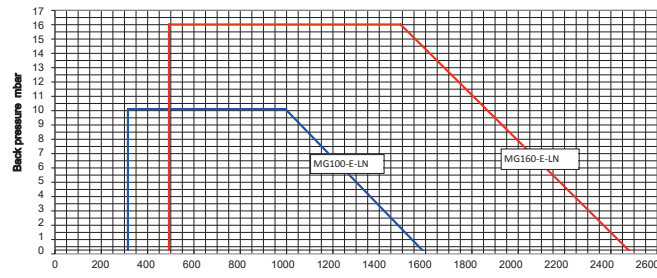

MG400-E-LN
MG400-I-E-LN

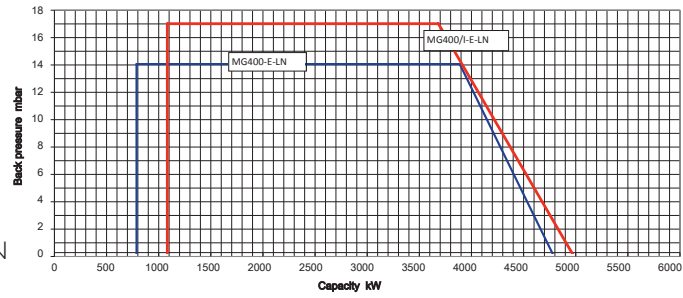

MG700-E-LN
MG900-E-LN

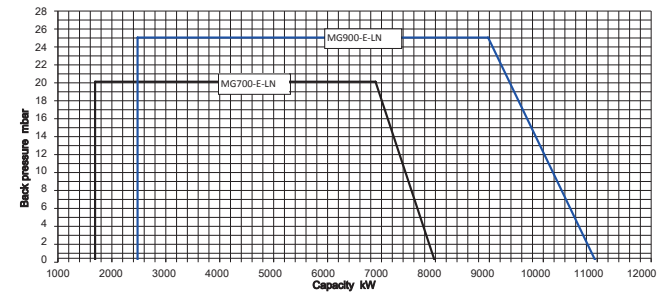

Dimensions

| Type | A | B | C | D | E | F | H | K | L |
|------------------|------|------|------|------|-----|-----|-----------|------|----------|
| | mm | mm | mm | mm | mm | mm | mm | mm | mm |
| MG40-E-LN | 651 | 630 | 390 | ∅156 | 240 | 309 | 550-600 | 140 | 4 × M 10 |
| MG80-E-LN | 801 | 790 | 512 | ∅206 | 240 | 375 | 600 | 180 | 4 × M 12 |
| MG100-E-LN | 833 | 880 | 588 | ∅250 | 300 | 395 | 600 | 216 | 4 × M 12 |
| MG160-E-LN | 953 | 880 | 711 | ∅286 | 300 | 407 | 1000-1039 | 254 | 4 × M 16 |
| MG400/400-I-E-LN | 1103 | 1040 | 839 | ∅330 | 300 | 547 | 725-1039 | 272 | 4 × M 16 |
| MG700/900-E-LN | 1516 | 1282 | 1166 | ∅476 | 400 | 783 | 1039 | ∅540 | 6 × M 20 |

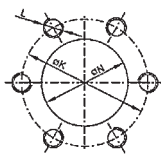
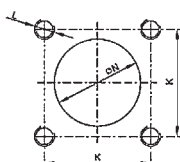
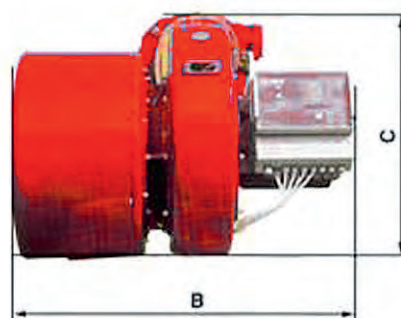
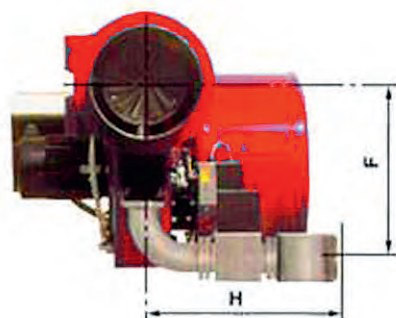
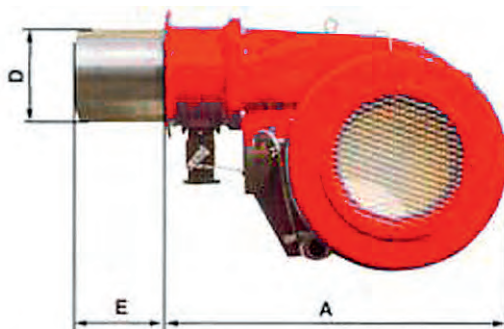

Monoblock Burner
– Low NOx
Gas Burner MG-E-LN